

# KITE MINI

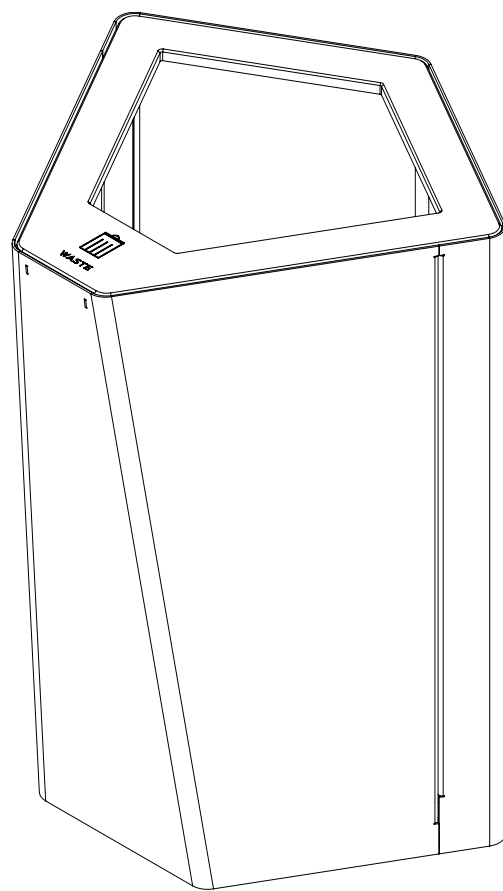

# KITE MINI

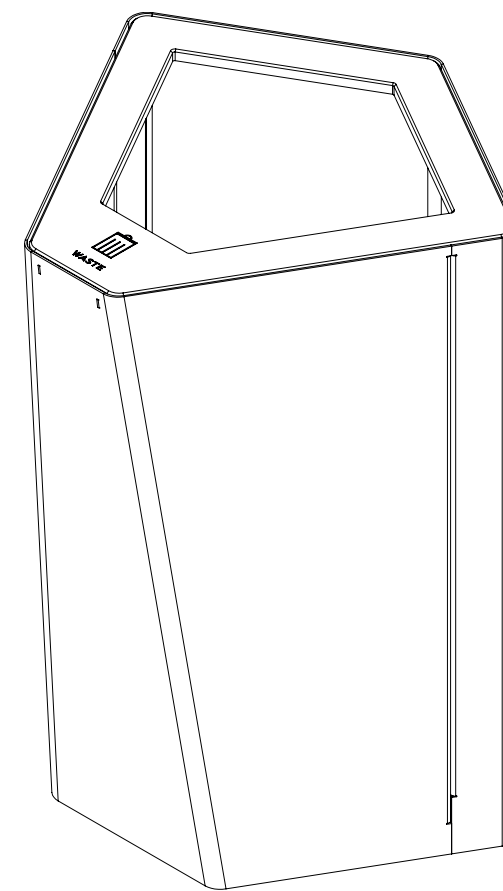

# COMPONENTS

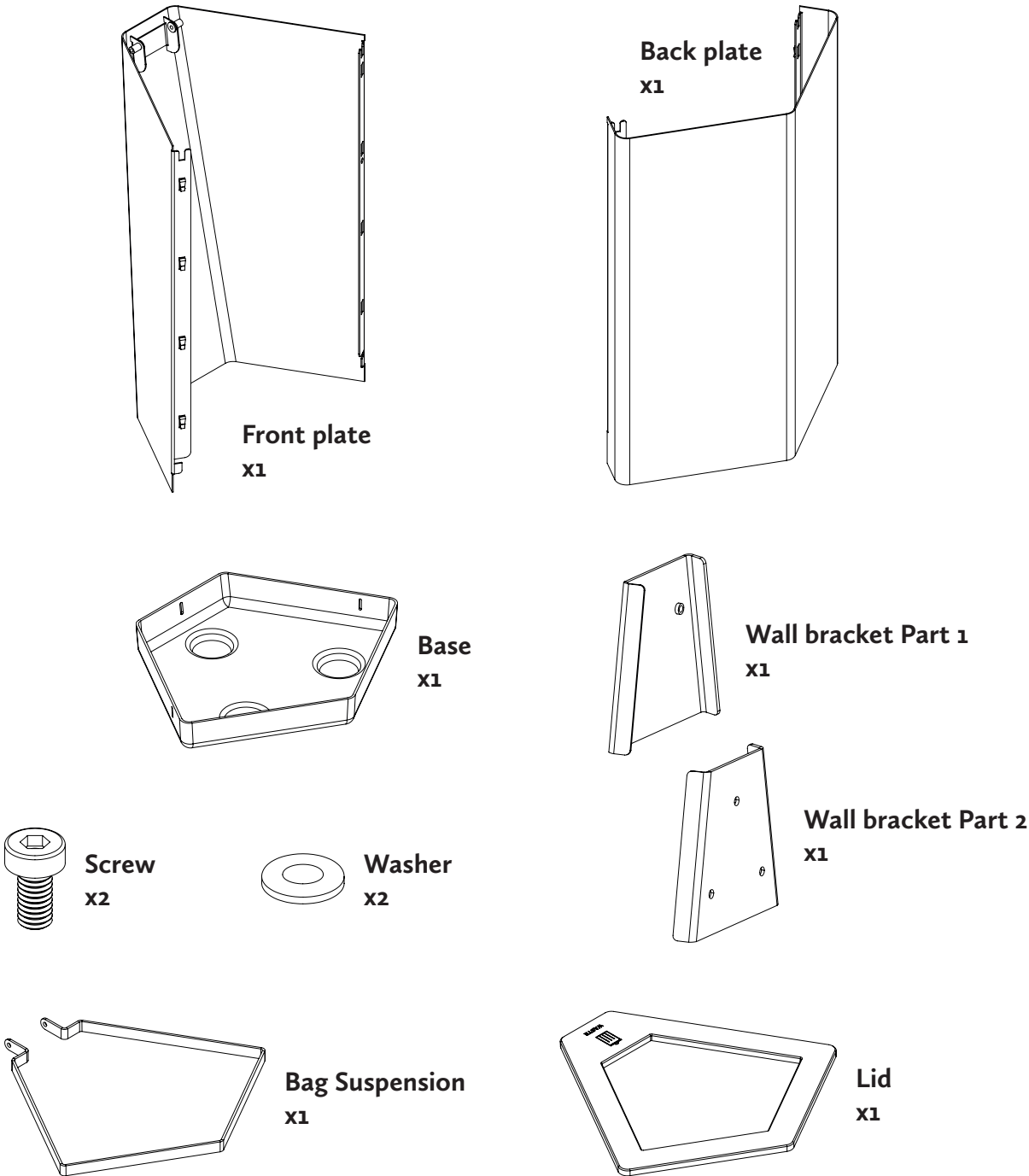

**Kite Mini Floor:** The wall brackets (part 1 and 2) are not included.

**Kite Mini Wall:** Wall Brackets are included. The frame is prepared with holes for installation, right or left hung.

# FOR WALL ASSEMBLY: ASSEMBLE AS SHOWN

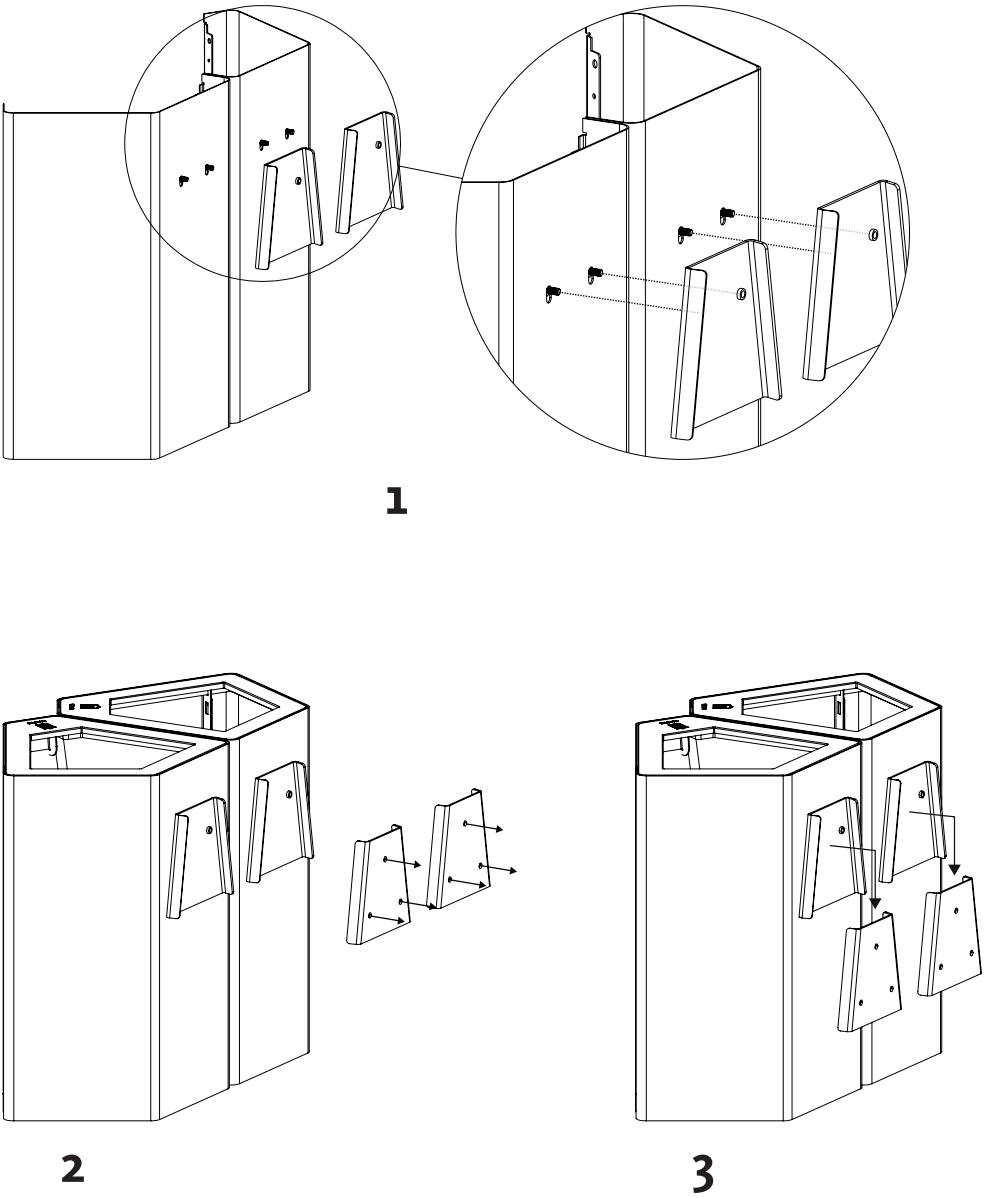

Note that the hole spacing differs depending on whether it is left- or right hung.

1. Fix the wall bracket part 1 (with two holes) to the back plate using the screws and washers provided. Tighten the screw and washer from the inside frame and out through the holes.
2. Fix the wall bracket part 2 (with three holes) against the wall with suitable screw and plug. See separate assembly template for recommended height and distance.
3. Slide Kite Mini over the fixed bracket on wall.

# ASSEMBLE AS SHOWN

## 4

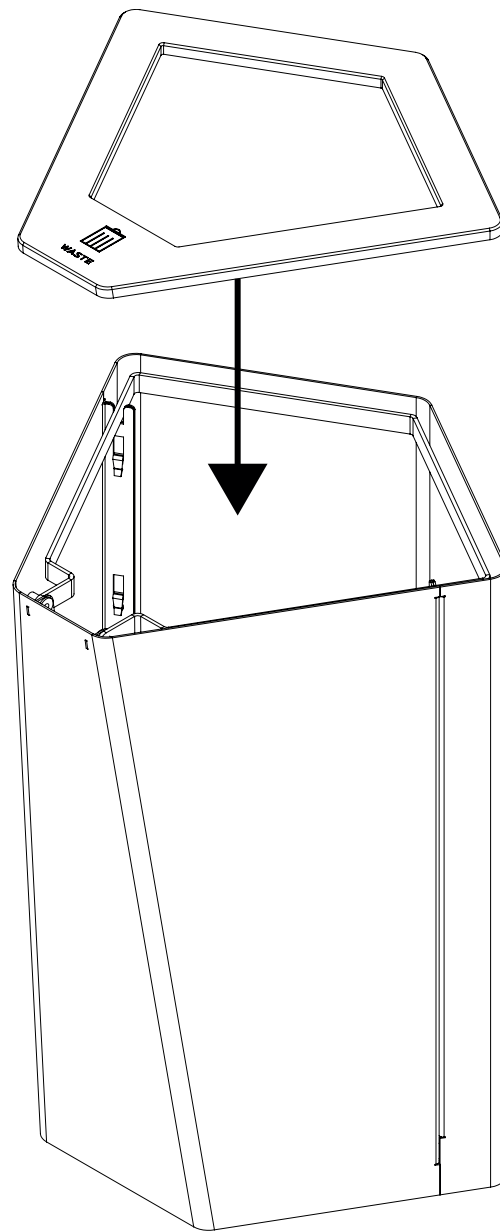

Place the lid.

# ASSEMBLE AS SHOWN

## 1

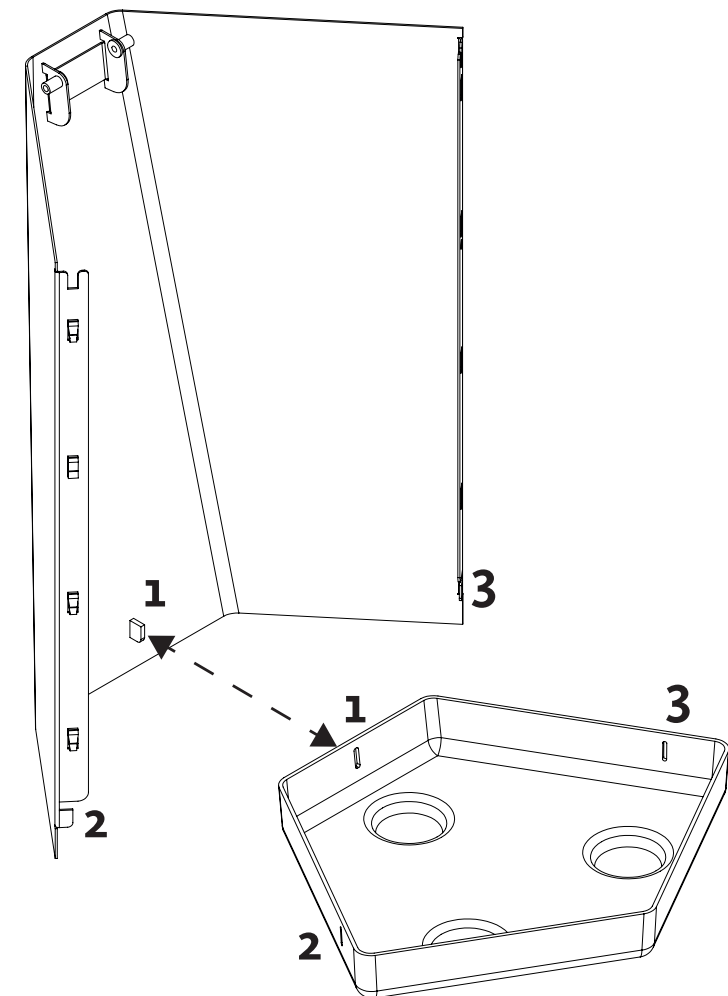

Hold the front plate in one hand and the base in the other hand. Click in the three sides of the front plate into the grooves of the base.

# ASSEMBLE AS SHOWN

## 2

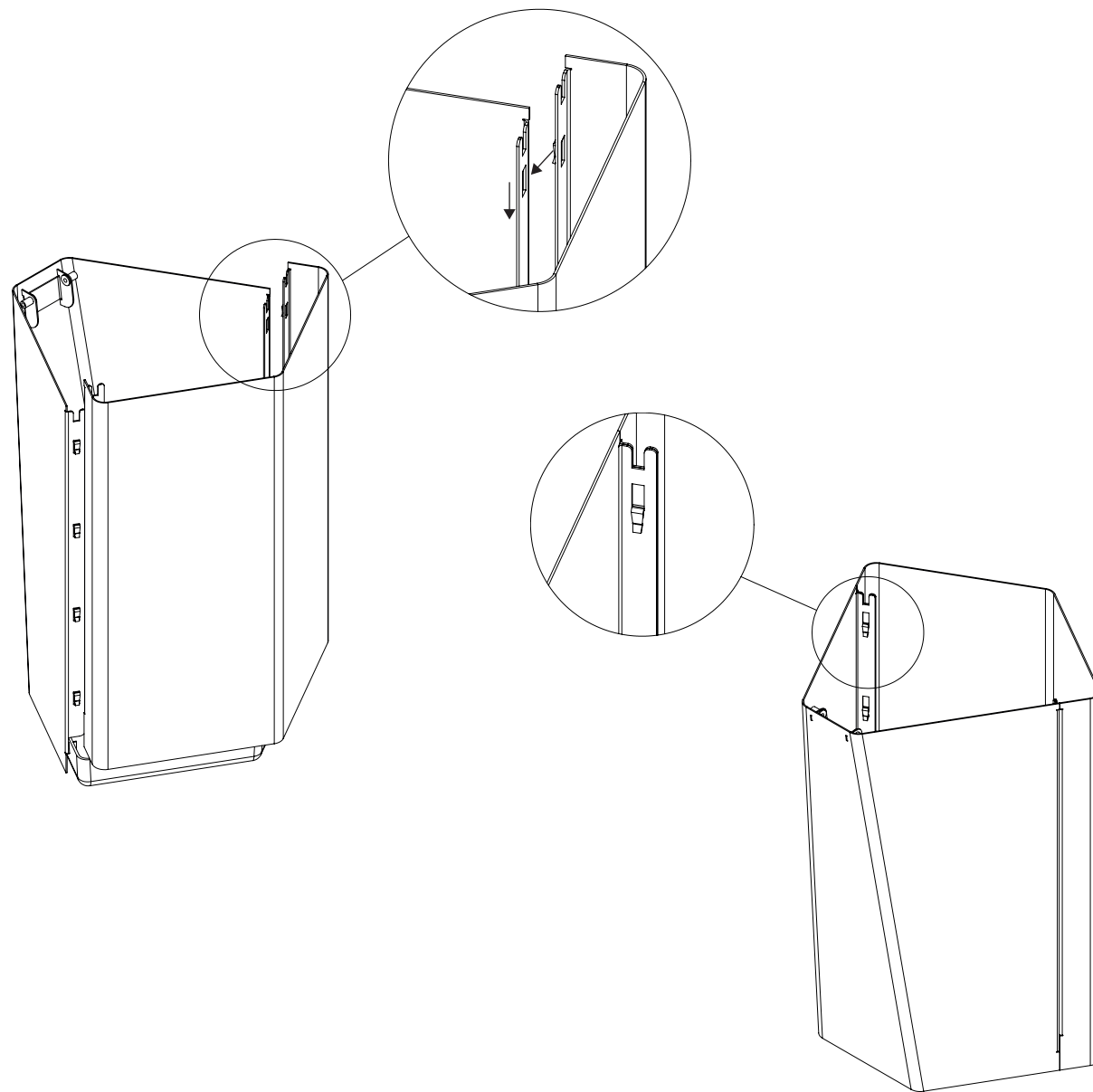

Attach the front and back plates to each other by inserting the sides of the back plate so they fit into the front plate's hole spacing. Make sure the top edges align.

**Kite Mini Wall:** For easier assembly go to Page 6. Perform part 1 on page 6 before returning to this page.

# ASSEMBLE AS SHOWN

## 3

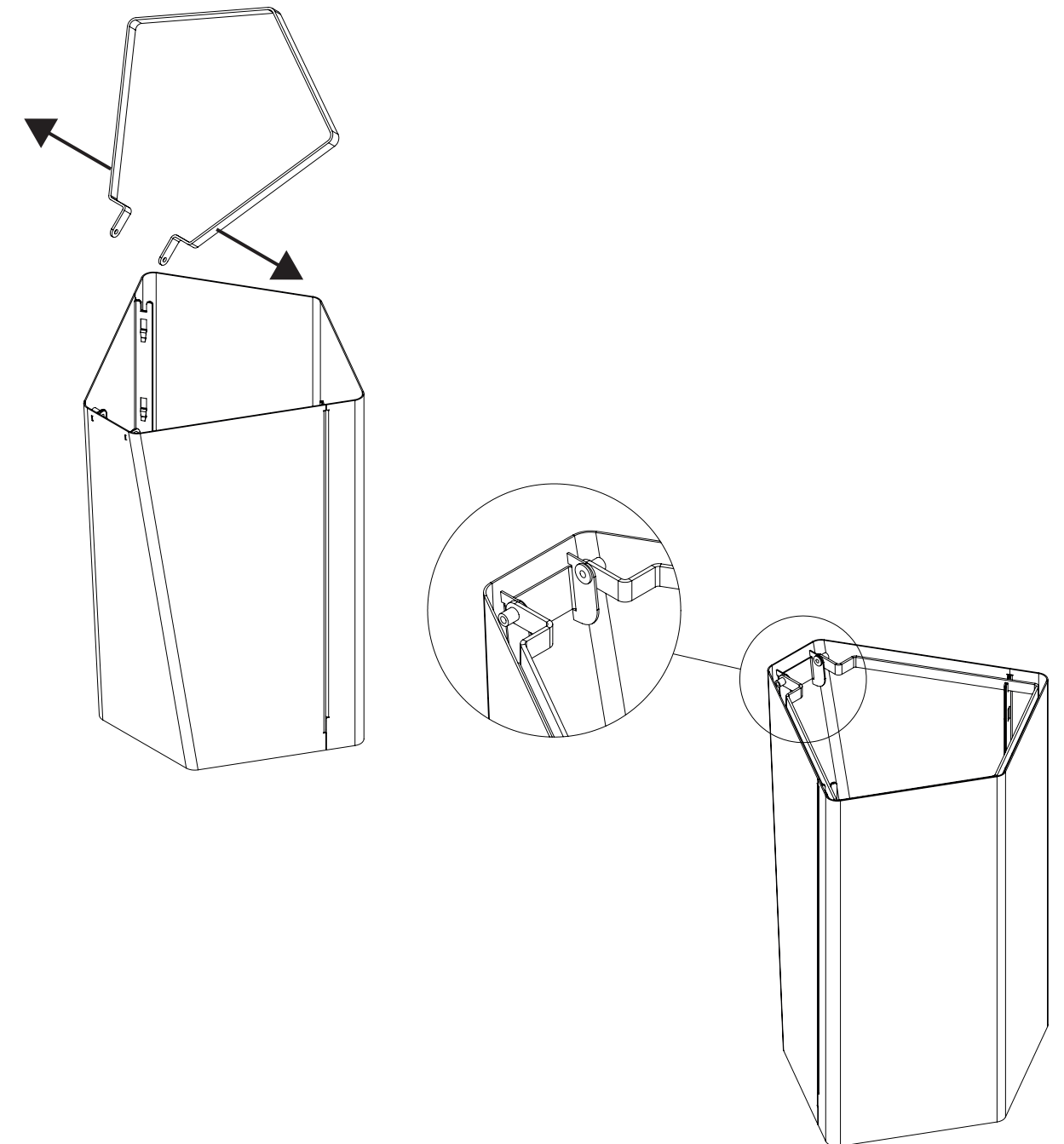

Bend the open ends of the bag holder apart and place the holes onto the cylinders that are attached to the top of the front plate.