

1. Loosen and unscrew the Allen screw with a 3 mm Allen key. (*Hex key*)

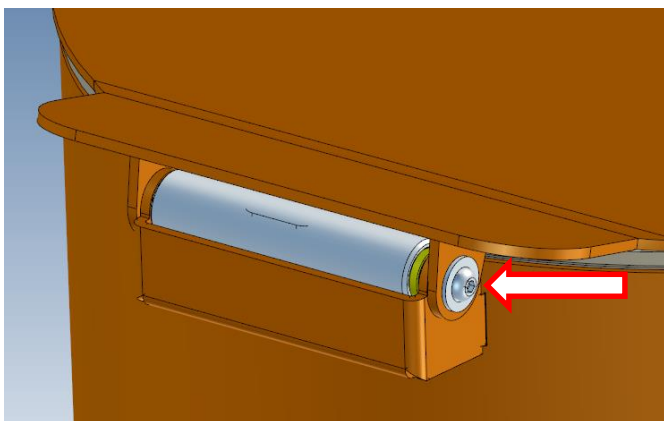

2. Loosen the bottom stop screw half a turn with a 3 mm Allen key, then unscrew the groove screw on the side.

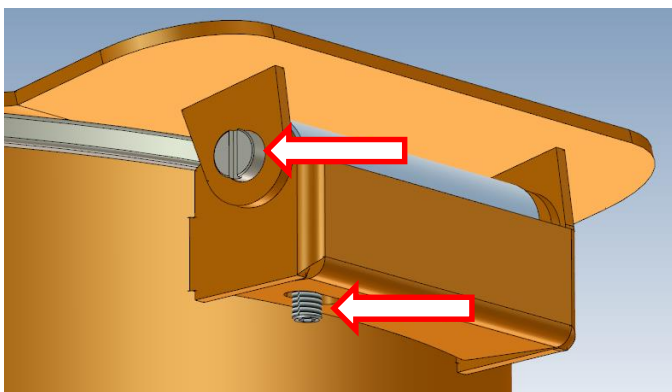

3. Using a small tool, push in the square socket about 10 mm, be careful not to damage the threads. Remove the lid and lift up the damper unit.

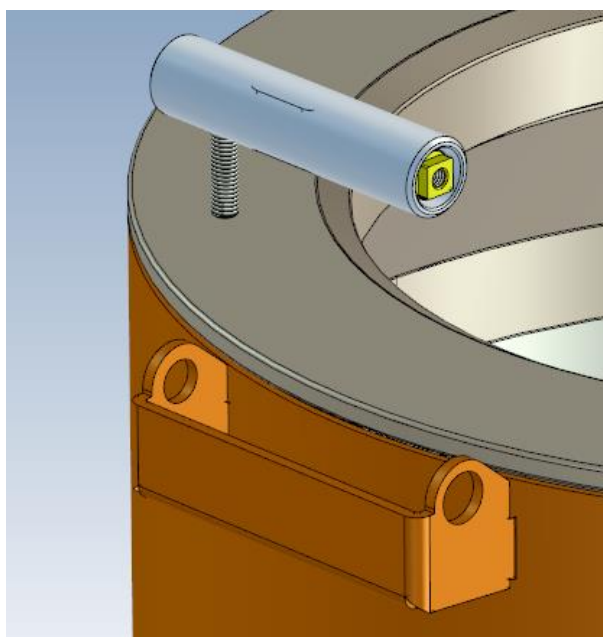
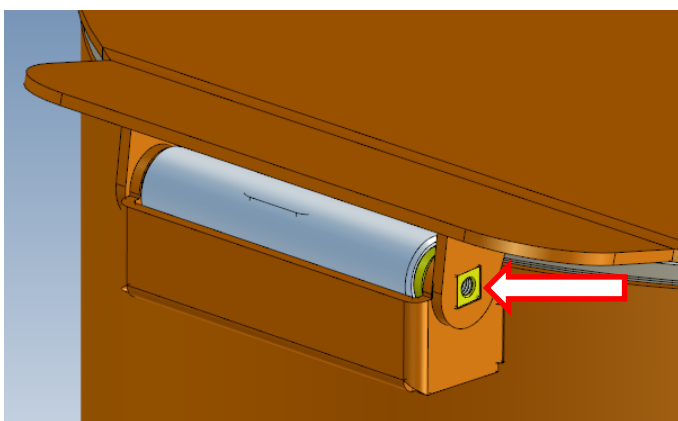

4. Push out the damper (A), and the square socket.

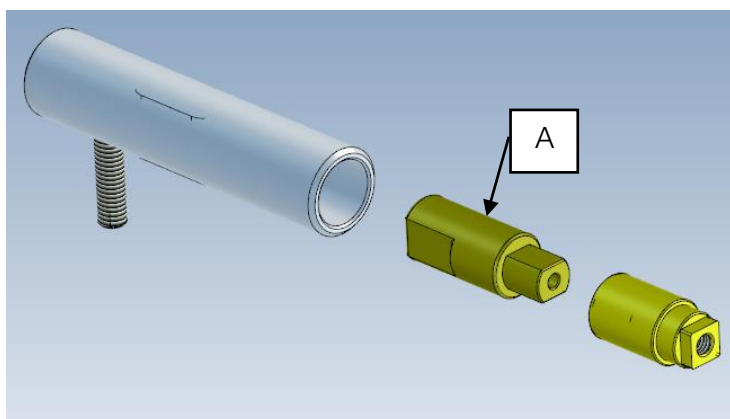

5. Replace the damper with the new one, attach the square socket to the damper and reinsert it into damper unit. Make sure that the larger key grip on the damper comes parallel to the stop screw. *The smaller key grip on the damper should be about 90° to this. This is set at the factory and cannot be changed.*

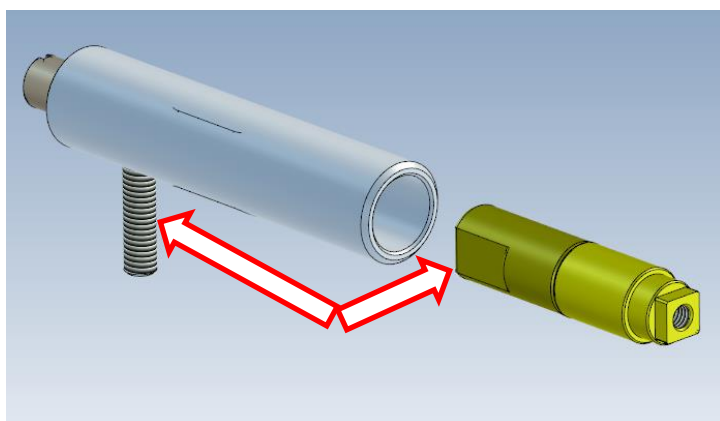

6. Put back the damper unit and lid, then screw in the groove screw. Lift the damper unit to the correct position by using the stop screw. Note, the lid must be in the down position.

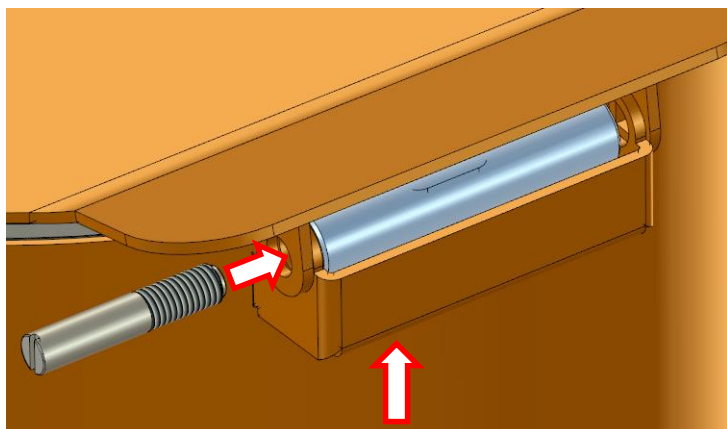

7. Screw in the groove screw until the square socket is fully inside the lid's ear. Then turn the groove screw back $\frac{1}{4}$ - $\frac{1}{2}$ turn. **Tighten the stop screw at the bottom.**

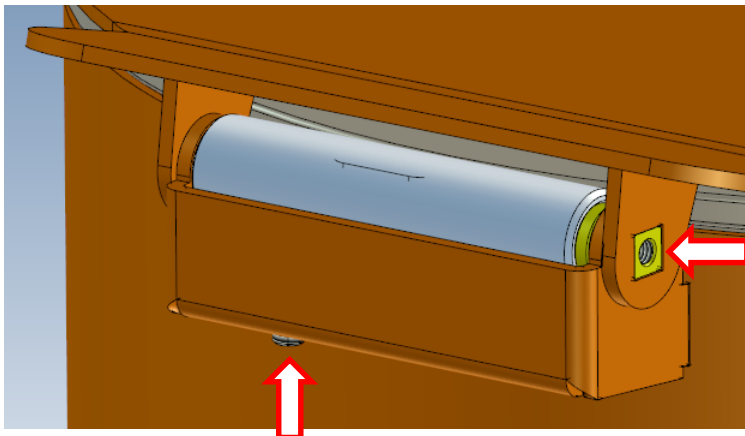

8. Screw on the washer and Allen screw. Check that the lid opens easily and that it dampens when closed.

